

IMPORTANT NOTE

This plan is prepared for ROMANA INVESTMENTS PTY LTD from existing records for the purpose of an application for new constructions on the land and should not be used for any other purpose. Tree spreads are diagrammatic only and may not be symmetrical.

Prior to any demolition, excavation or construction on the site, the relevant authority should be contacted for possible location of further underground services and detailed locations of all services. This note is an integral part of the plan.

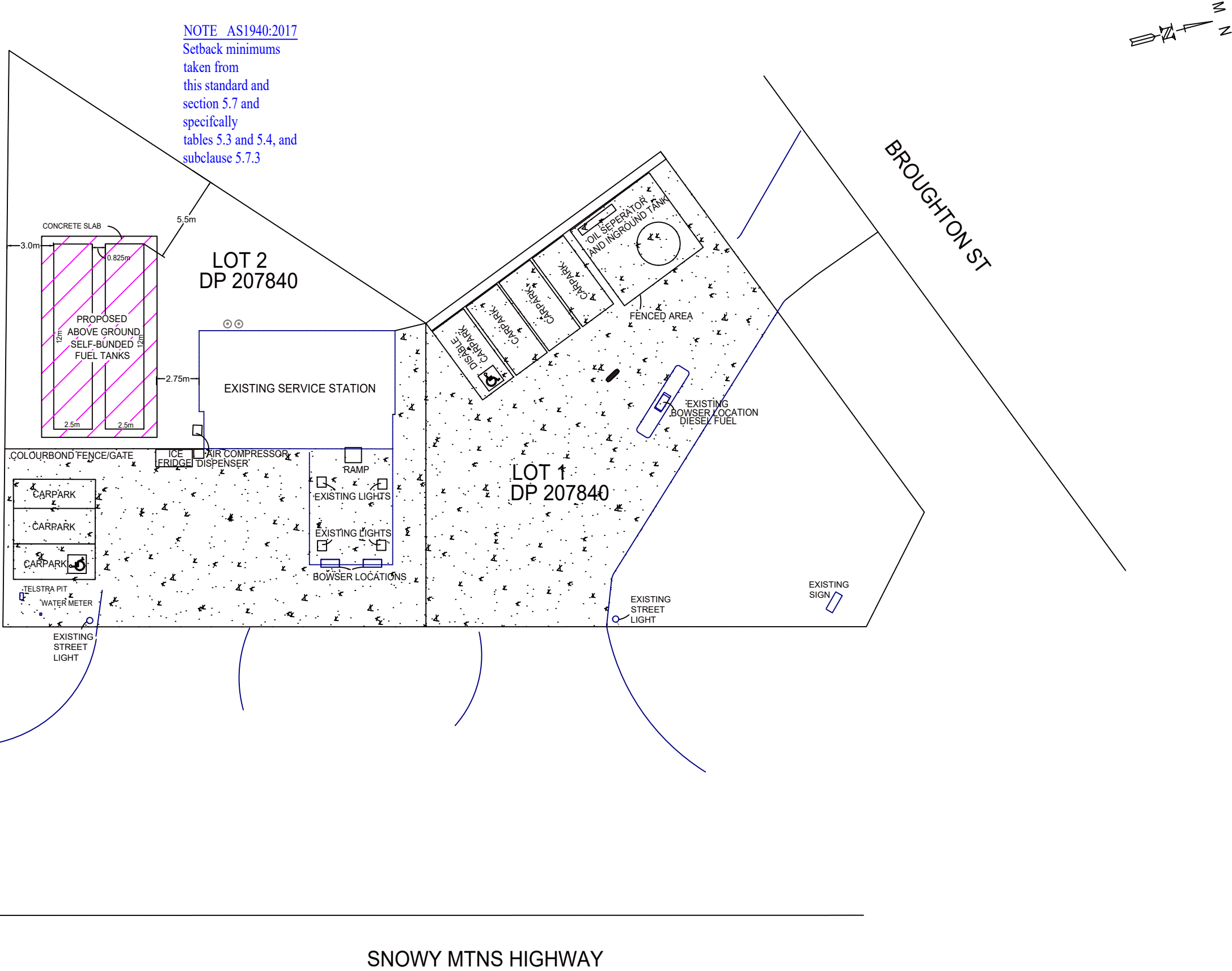

SCALE 1:200 A3								CLIENT: Sri Kalunath Pty Ltd	Sheet 1 of 1
ORIGIN OF LEVELS <ORIGIN>								PROJECT: PROPOSED ABOVE GROUND TANKS SITE PLAN	Rev 1 Size A3
CONTOUR INTERVAL ... <ORIGIN>								LOCATION: LOT 1 & 2 DP 207840	DATE: 21/08/2023
DATUM: <DATUM>	1	ISSUED FOR DEVELOPMENT APPLICATION	KK	KK	21/08/23			CNR SNOWY MTNS HWY & BROUGHTON ST, TUMUT	PLAN No. 230022
	No.	REVISIONS & AMENDMENTS	Drawn	Approved	Date				

